



Rubek LOW PROFILE model automatic sliding door operator

Modern - Quiet – Very Reliable

“Built for the life of your building”

The Rubek Low Profile automatic sliding door operator ensures a low maintenance future and low costs as it is without doubt the strongest low profile automatic sliding door operator in Australia. Built with faultless design and reliability in mind it is specifically suitable for entrances with restricted head height or for above ceiling automatic door applications.

Design

Designed and made in WA with Smart Electronics that set our safety levels above the current Building Code requirements and Australia Standards and guidelines.

Smart

Smart because we keep it simple. Any service personnel can look after your Rubek door operator without affecting the warranty keeping costs down because our clients are not tied to one service provider. Smart because all the parts are individually replaceable – which saves you money over other brands that replace modules.

Power

Back-up Uninterruptible Power Supply to ensure in excess of 1500 operations in the event of a mains power failure with options to expand

Value

No inbuilt obsolescence in any Rubek operator. We avoid expensive modular replacement systems and instead design so all individual parts can be replaced. In fact we can still maintain operators as far back as the original installations in 1994. In terms of quality and product longevity no other automatic door company comes close to Rubek.

Confidence

When you chose a Rubek product you have the confidence that your decision is based on 24 years of success for that same product. It's true that some other brands have been around longer but not one has a product set that dates back to 1994. Typically some other brands products are obsolete within 5 to 7 years.

Expandable

If you need added monitoring or control – no problem. Rubek designed operators are adaptable to your specific needs.

Communication

Provided with a main interface board allows easy interfacing to new or existing systems. Whether its Security, Fire, Building Management Systems or SCADA our operators can be connected.

Security

With Rubeks secure motor locking system you can be assured your property is safe when locked. And if an emergency should arise you are 100% guaranteed that our locks will not fail to release and will therefore always allow safe egress as required by the BCA/NCC.

Safety

Fully compliant to the BCA/NCC – the ONLY legal requirement for automatic doors. Meets or exceeds all aspects of safety from AS5007:2007 guidelines.

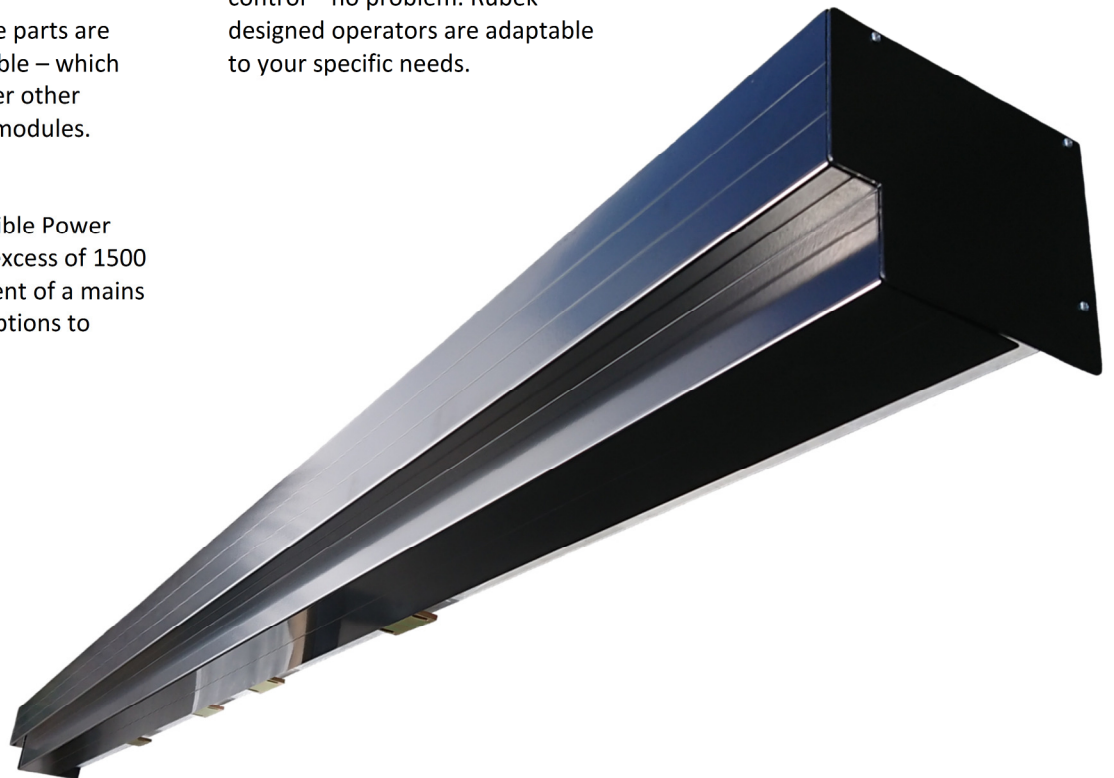

The Most Versatile Automatic Sliding Door Operator in Australia

- Rubek offers more to our clients than any other brand
- A LIFETIME warranty on any model Rubek automatic sliding door housing and 24 month parts 12 month labour warranty that we backup 24/7, 365 days per year - NO charging for warranty service calls after hours
- A 4mm extruded aluminium housing
- Over 1500 operations on one standard battery alone with options to expand
- Free consultation and training on any aspect of automatic door design, installation and maintenance

Product Longevity - No obsolescence

- Full support and maintenance for our first operators manufactured in 1994 to present
- All parts are always available for all models
- All operators can be upgraded with the latest electronic assemblies
- We simply don't believe in building in product obsolescence

Low Maintenance

- Proven to always save money
- Simple setup adjustments without the need for proprietary programmers which keeps service costs down because our clients are not locked in to any one service provider
- Call when needed or set up a scheduled maintenance agreement with our friendly service department
- Free consultation on any aspect of automatic door design and installation. Free training for clients to look after their door operators themselves if they so wish

Quality Design & Reliability

- Rubek make the strongest door operator housings in Australia by far
- Designed and built to last for the life of the buildings they occupy to save our clients from costly replacements
- Maximum door control and balance through multiple adjustments points
- Door hanger brackets fabricated from 6mm laser cut steel plate to eliminate bending
- Fully raced nylon anti-rise wheels provide maximum safety to stop door derailment
- Large nylon track wheels with quality bearings ensure long smooth running life
- Kevlar reinforced drive belt for quiet operation
- Replaceable hard anodised track for longevity
- Double bolted carriage rails which means no door hanger bracket failure and the risk of dropping doors
- Pelmet cover with safety hinge to remove the risk of falling

Compliance

- All models are fully Compliant to the ONLY legal requirement in Australia, the BCA/NCC
- Rubek door operators exceed relevant Australian Standards and Guidelines
- Electronics designed in Australia specifically for Australian door, power and regulatory requirements

Warranty Information

| | |
|------------------|---|
| Parts | 2 years |
| Labour | 1 year |
| Operator housing | Lifetime (when installed as per drawings) |

Maintenance

- Once per year is sufficient for most installations. Twice a year is recommended for very busy doorways.
- Rubek can offer factory maintenance programs to suit your needs if required, just call our service team on (08) 9302 3200 for free advice and assistance.

Australia's Strongest
Automatic Door Operators
that any service company can maintain

Features

- ✓ Heavy duty 4mm extrusion designed to last the life of the buildings they are installed in
- ✓ Double bolted carriage rails with deep extrusion so doors remain safe and can't drop
- ✓ Framed or frameless doors to 250kg as standard
- ✓ 4mm gusseted anti-rise bar that won't buckle so no door derailments and expensive housing replacements
- ✓ 6mm steel door hanger brackets which won't bend under load
- ✓ 5mm steel drive brackets which won't twist under load
- ✓ 50mm nylon polychloroprene wheels with sealed bearings for smooth quiet operation
- ✓ 15mm Kevlar reinforced drive belt rated to 1250kg
- ✓ Large 3.3Ah 12Vdc battery backup for continuous operation and security when the mains power is out. Additional batteries can be added
- ✓ Easy screwdriver adjustment of operating parameters
- ✓ Sensor recess built into pelmet
- ✓ Suitable for framed, frameless, or timber doors
- ✓ Accepts all control inputs with outputs that make it easy to monitor

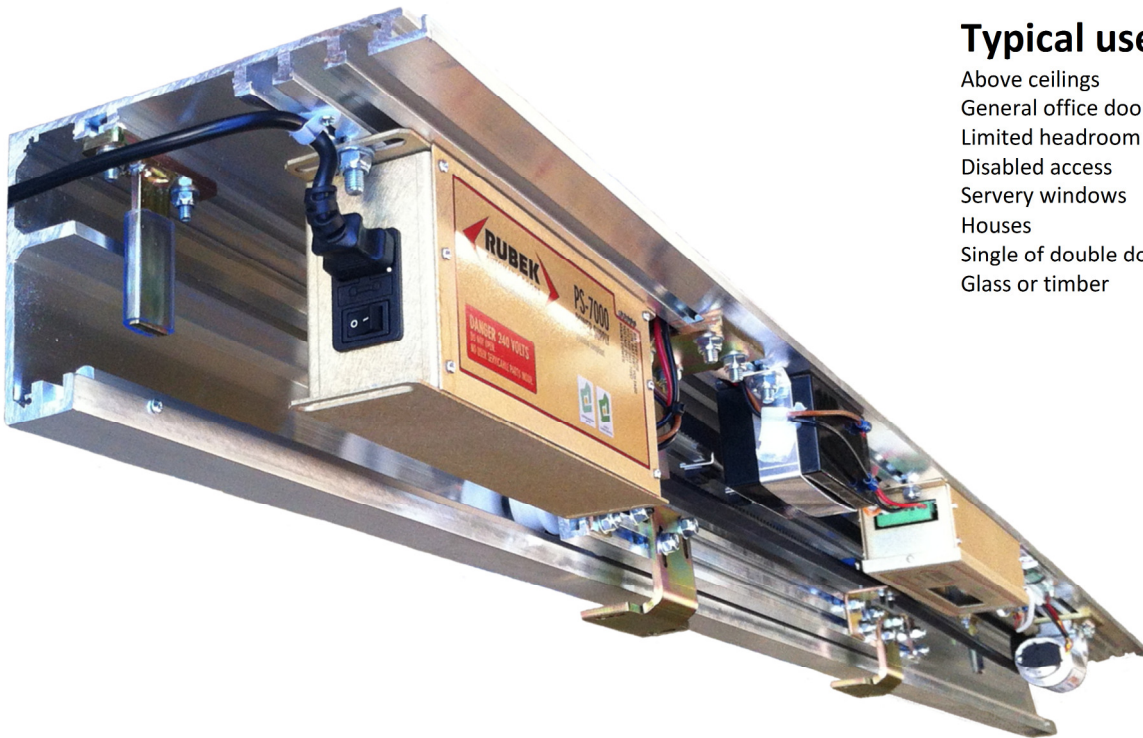
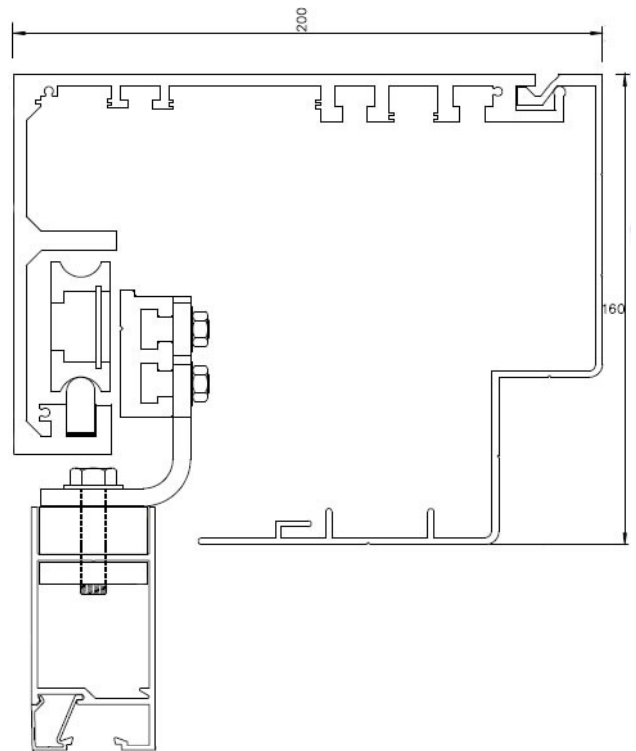

Typical uses

Above ceilings
General office doors
Limited headroom doorways
Disabled access
Servery windows
Houses
Single or double doors
Glass or timber

Australia's Strongest
Automatic Door Operators
that any service company can maintain

Rubek R7000 Controller

Self-monitoring and optimised for safety
Easy adjustments – No programmers required allowing
all service personnel to make adjustments
LED displays for service and diagnostics
Fully RoHS compliant.

Electronics can fail quickly in corrosive environments so
Rubek offers optional protection to maximise
component and circuit board life where all circuit
boards, connectors and cable ends are treated to seal
and keep corrosive elements out. Talk to us if you have a
harsh environment and you need a door operator to last.



Rubek PS-7000 Intelligent Power Supply

The PS7000 has a built in battery charger to keep
battery(s) in top condition
The front panel includes LED monitoring for 240Vac,
12Vdc and Battery
Automatically switches to battery power whenever
240Vac is off so that the current door operation mode is
not interrupted.



Rubek IM-7000 Interface Board

Rubek makes it easy for security, fire systems and building management systems be connected to our sliding door operators.

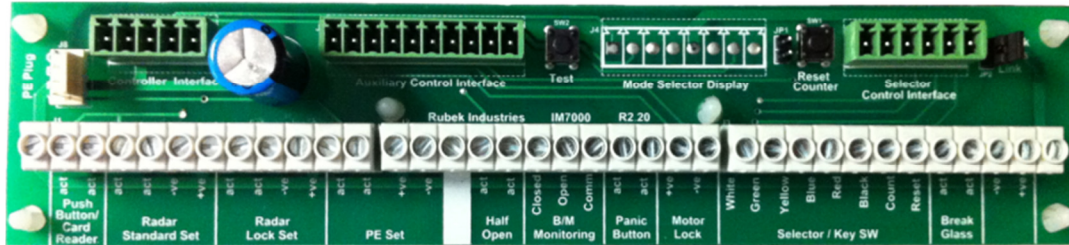

Fire system connections – To allow a fire signal to operate the door to an open (or closed) position

Security connection – For internal exit button and entry card reader etc.

Building Management System connections – Allows monitoring of door position status

Door Test button – to operate and cycle the door

Panic button connection – to close and lock the door(s) at maximum speed in the event of an emergency

Half Open option – Operated by selector or key-switch to only open the door(s) to the halfway position on activation



Drive Systems and locking – Proven performers over the last 24 years

Standard 160W motor and gearbox.
Shown with motor lock, encoder and 6mm
steel mounting.



Technical Specifications

| | |
|---|--|
| Motor / gearbox | 160W Brushed motor and matched 1:10 ratio gearbox – Dunkermotoren Germany |
| Lock | Fail safe electric motor lock complying to BCA/NCC (optional) |
| Height (overall) | 160mm |
| Depth | 200mm |
| Extrusion thickness | 4mm. Fully gusseted for added strength |
| Opening and closing force maximum | 130Nm |
| Opening speed adjustment | Variable from 50mm/s to 1000mm/s |
| Closing speed adjustment | Variable from 50mm/s to 1000mm/s |
| Hold open time | Variable from 1sec to 30sec |
| Maximum total door weight | Single 220kg, Double 250kg |
| Mains supply voltage / frequency | 240Vac +-10% @ 50Hz |
| Power consumption | 126W |
| Fire connection | Yes |
| Security interface connection | Yes |
| DC output for external control | 17.5Vdc |
| Digital read out | Yes – LED displays |
| Battery backup (expandable) | 12Vdc 7Ah Lead acid battery |
| Mains fail operations | ~1500 operations & ~4 hours locking with single battery |
| Half open setting for doors | Yes |
| Panic | Yes (optional) |
| Low battery alarm | Yes |
| Power supply indicators | Yes – LED's |
| Self-monitoring controller | Yes |
| Drive | Kevarl reinforced 15mm toothed belt rated to 1250kg |
| Steelwork | Laser cut 6mm door brackets and 5mm belt drive brackets |
| Sensors | BEA (Belgium designed) |
| Safety stop and reverse | Yes – 10 retrys |
| Glass, timber, aluminium or steel doors | Yes |
| Single, bi-parting and telescopic options | Yes |

Manufacturing Information

All models of Rubek automatic sliding door operators are manufactured in Western Australia

Component manufacturing location

| | |
|---|--|
| Extruded 6060T5 aluminium track housing | Australian manufactured |
| Extruded 6060T5 aluminium pelmet cover | Australian manufactured |
| Extruded 6060T5 aluminium door carriage rails | Australian manufactured |
| Motor, gearbox and lock | German made and supplied |
| Controller | Western Australia designed and manufactured |
| Power supply | Western Australia designed and manufactured |
| Interface board | Western Australia designed and manufactured |
| Relay boards | Western Australia designed and manufactured |
| Steelwork | Western Australia designed and manufactured |
| Zinc plating | Western Australia |
| Anodizing | Western Australia |
| Powder coating | Western Australia |
| Fixings | Western Australia supplied |
| Wiring | Western Australia supplied |
| Reed switches | Western Australia supplied |
| Drive belt | German manufactured and Western Australia supplied |
| Sensors | BEA Belgium designed, BEA China manufacture and supplied |

Australia's Strongest
Automatic Door Operators
that any service company can maintain

Australian Compliance

| Type | Rubek | Requirement |
|---|--|--------------------------------|
| Building Code Australia (National Construction Code) | Compliant (Exceed requirements) | Mandatory compliance |
| Australian Standard AS1428 | Compliant (Exceed requirements) | Mandatory compliance |
| Australian Standard AS NZS 61558 | Compliant | Mandatory compliance |
| EMC N10882 | Compliant | Mandatory compliance |
| Australian Standard AS5007:2007 (Guideline) | All Rubek products exceed all aspects of safety and endurance | Non-mandatory (Guideline only) |

Drawings

All drawings are available from our website under the Downloads tab at www.rubek.com.au

